

Seal

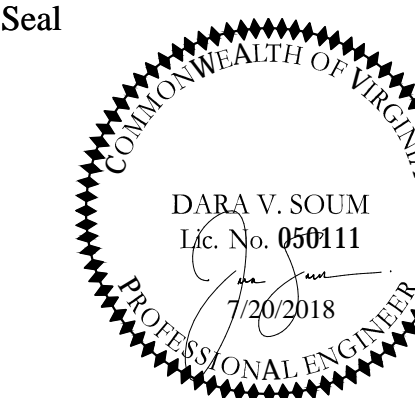

Approvals \_\_\_\_\_ Date \_\_\_\_\_

DESIGN TEAM SUPERVISOR \_\_\_\_\_

CHIEF T.E. & O. BUREAU \_\_\_\_\_

TRAFFIC SIGNAL ENGINEER \_\_\_\_\_

DEPARTMENT OF TRANSPORTATION \_\_\_\_\_

Revisions \_\_\_\_\_ Date \_\_\_\_\_

\_\_\_\_\_

\_\_\_\_\_

\_\_\_\_\_

\_\_\_\_\_

\_\_\_\_\_

\_\_\_\_\_

\_\_\_\_\_

\_\_\_\_\_

\_\_\_\_\_

\_\_\_\_\_

\_\_\_\_\_

\_\_\_\_\_

\_\_\_\_\_

\_\_\_\_\_

\_\_\_\_\_

\_\_\_\_\_

\_\_\_\_\_

\_\_\_\_\_

\_\_\_\_\_

\_\_\_\_\_

\_\_\_\_\_

\_\_\_\_\_

\_\_\_\_\_

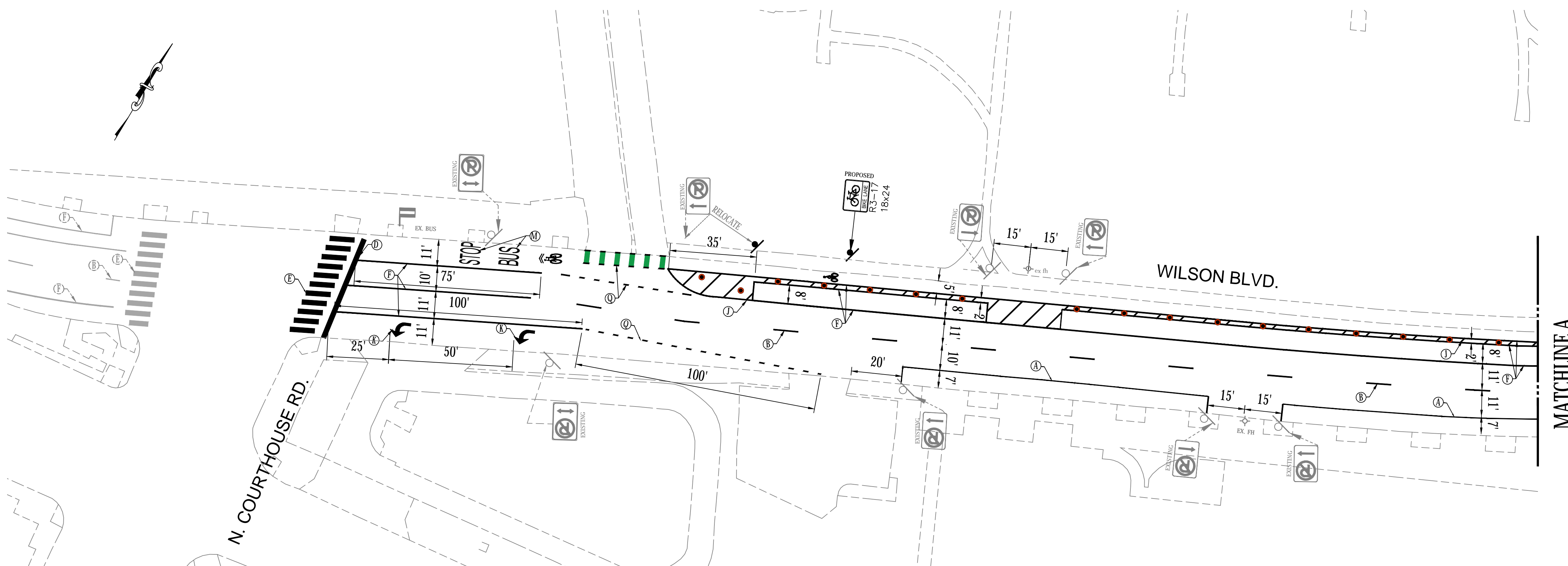

**STANDARD PAVEMENT MARKING LEGEND:**

Ⓐ TYPE B CLASS 1.....WHITE 4" WIDTH	PARKING LANES, EDGE LINES, LANE LINES
Ⓑ TYPE B CLASS 1.....WHITE 4" WIDTH, 10' LONG, 30' SPACING	DASHED LANE LINES
Ⓒ TYPE B CLASS 1.....WHITE 4" WIDTH, 2' LONG, 10' SPACING	LANE TRANSITIONS, TURN LANE SKIPS
Ⓓ TYPE B CLASS 1.....WHITE 18" WIDTH	STOP BARS
Ⓔ TYPE B CLASS 1.....WHITE 24" WIDTH	CONTINENTAL CROSS WALKS
Ⓕ TYPE B CLASS 1.....WHITE 6" WIDTH	TURN LANES, TRANSVERSE CROSSWALKS, BIKE LANES
Ⓖ TYPE B CLASS 1.....YELLOW 4" WIDTH, 10' LONG, 30' SPACING	DIVIDED TRAFFIC, TWO WAY TURN LANES
Ⓗ TYPE B CLASS 1.....YELLOW 4" WIDTH	EDGE LINES
Ⓙ TYPE B CLASS 1.....YELLOW 4" WIDTH, DOUBLE LINE, 4" SPACING	CENTERLINES
Ⓚ TYPE B CLASS 1.....WHITE 6" WIDTH, 10' SPACING @45 DEGREE	HATCH LINES, SAFETY ZONES
Ⓛ TYPE B CLASS 1.....WHITE SINGLE ARROW	TURN LANES
Ⓜ TYPE B CLASS 1.....WHITE COMBINATION ARROW	TURN LANES
Ⓝ TYPE B CLASS 1.....WHITE 8" LETTERS	PAVEMENT LETTERS (STOP, YIELD, BUS, ONLY etc.)
Ⓞ TYPE B CLASS 1.....WHITE 6" WIDTH, 10' SPACING	LANE TRANSITIONS, TURN LANE SKIPS
Ⓟ TYPE B CLASS 1.....WHITE 12" WIDTH, 20' SPACING @45 DEGREE	CORE MARKINGS
Ⓠ TYPE B CLASS 1.....YELLOW 12" WIDTH, 20' SPACING @45 DEGREE	GORE MARKINGS
Ⓡ TYPE B CLASS 1.....WHITE 6" WIDTH, 2' LONG, 4" SPACING	LANE TRANSITIONS
Ⓢ TYPE B CLASS 1.....WHITE 4" WIDTH, DOUBLE LINE, 4" SPACING	CURB EXTENSIONS

- SIGN AND PAVEMENT MARKING NOTES:**
- STREET WIDTH MEASUREMENTS ARE FROM FACE OF CURB TO FACE OF CURB. LANES ARE MEASURED FROM CENTER OF MARKING TO CENTER OF MARKING.
  - CONTACT DENNIS HOWELL OR HIS DESIGNEE AT 703-228-6598 OR (571) 437-1077 TO APPROVE MARKING LAYOUT 48 HRS. PRIOR TO INSTALLATION OF MARKINGS.
  - PAVEMENT MARKINGS TO BE IN ACCORDANCE WITH THE FOLLOWING AND ANY REVISIONS HERE TO:  
A) THE MANUAL ON UNIFORM TRAFFIC CONTROL DEVICES.  
B) ARLINGTON COUNTY MARKING STANDARDS.
  - ALL MARKINGS SHALL BE THERMOPLASTIC PER ARLINGTON COUNTY MARKING STANDARDS.
  - STOP BARS SHALL BE A MINIMUM OF 4' IN ADVANCE OF A MARKED CROSSWALK. IF THERE IS NO MARKED CROSSWALK, STOP BAR SHALL BE NO MORE THAN 30' FROM THE NEAREST EDGE OF THE INTERSECTED TRAVELED WAY.
  - CROSSWALKS SHALL BE 10' WIDE UNLESS OTHERWISE NOTED.
  - LEFT TURN ARROWS SHALL BE LOCATED 25' BACK FROM STOP BAR. FOR ADDITIONAL ARROWS FOLLOW COUNTY MARKING STANDARDS.
  - ON STREET PARKING LANE IS 7' WIDE (UNLESS OTHERWISE NOTED) AND MARKED WITH 4" WIDE WHITE LINES. BEGINNING AND END OF PARKING SHALL BE MARKED WITH AN END LINE PERPENDICULAR TO CURB EXCEPT AT NUBS OR WHERE OTHERWISE INDICATED.
  - SHARED LANE MARKINGS SHALL BE PLACED IN CENTER OF LANE, 250' APART UNLESS OTHERWISE SPECIFIED.
  - BIKE LANE SYMBOLS TO BE PLACED 330' APART UNLESS OTHERWISE SPECIFIED.

**LEGEND**

EXISTING		PROPOSED
	BUS STOP	
	FIRE HYDRANT	
	PARKING METER	
	SIGN	
	STRIPING	

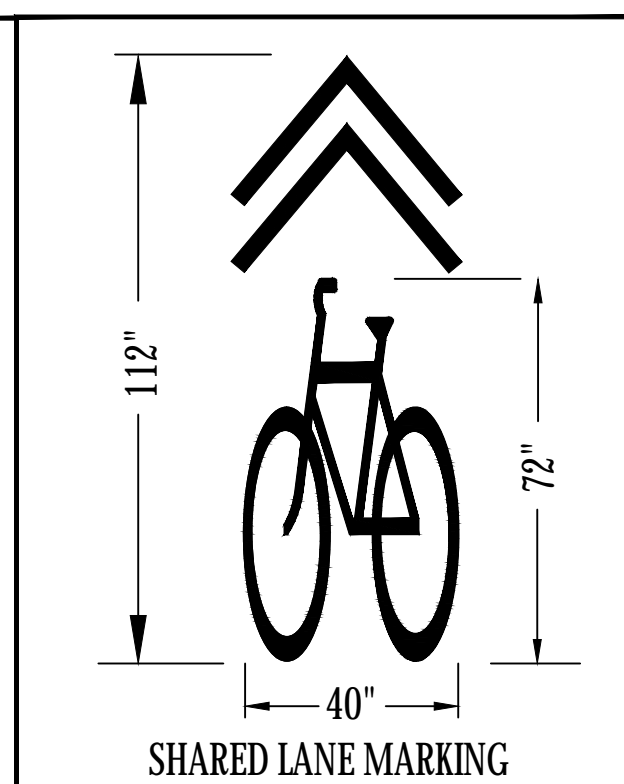
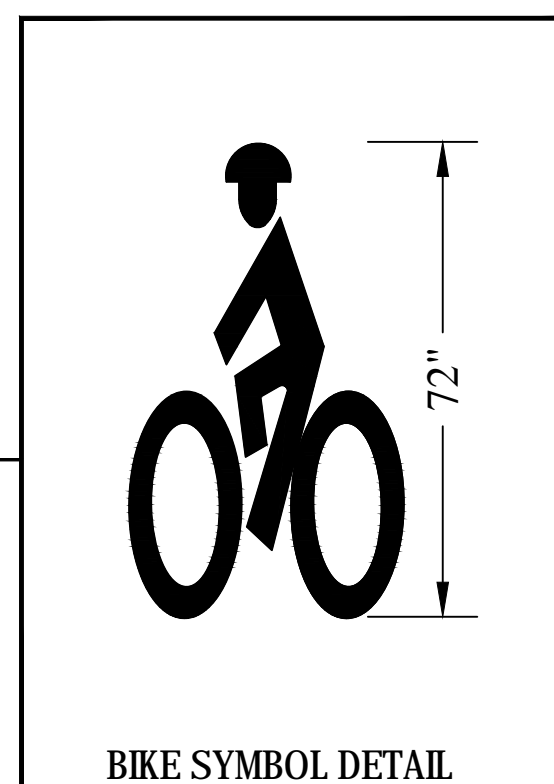
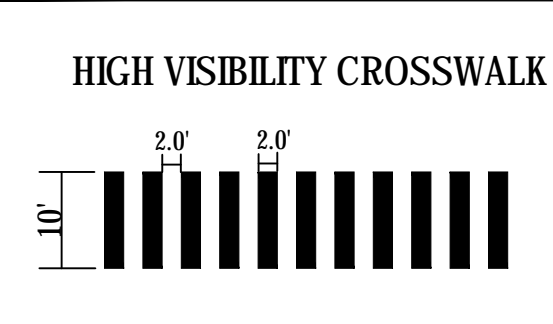



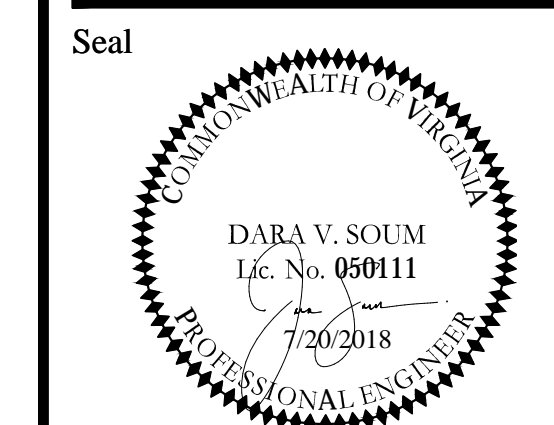

Approvals \_\_\_\_\_ Date \_\_\_\_\_

DESIGN TEAM SUPERVISOR \_\_\_\_\_

CHIEF T.E. & O. BUREAU \_\_\_\_\_

TRAFFIC SIGNAL ENGINEER \_\_\_\_\_

DEPARTMENT OF TRANSPORTATION \_\_\_\_\_

Revisions \_\_\_\_\_ Date \_\_\_\_\_

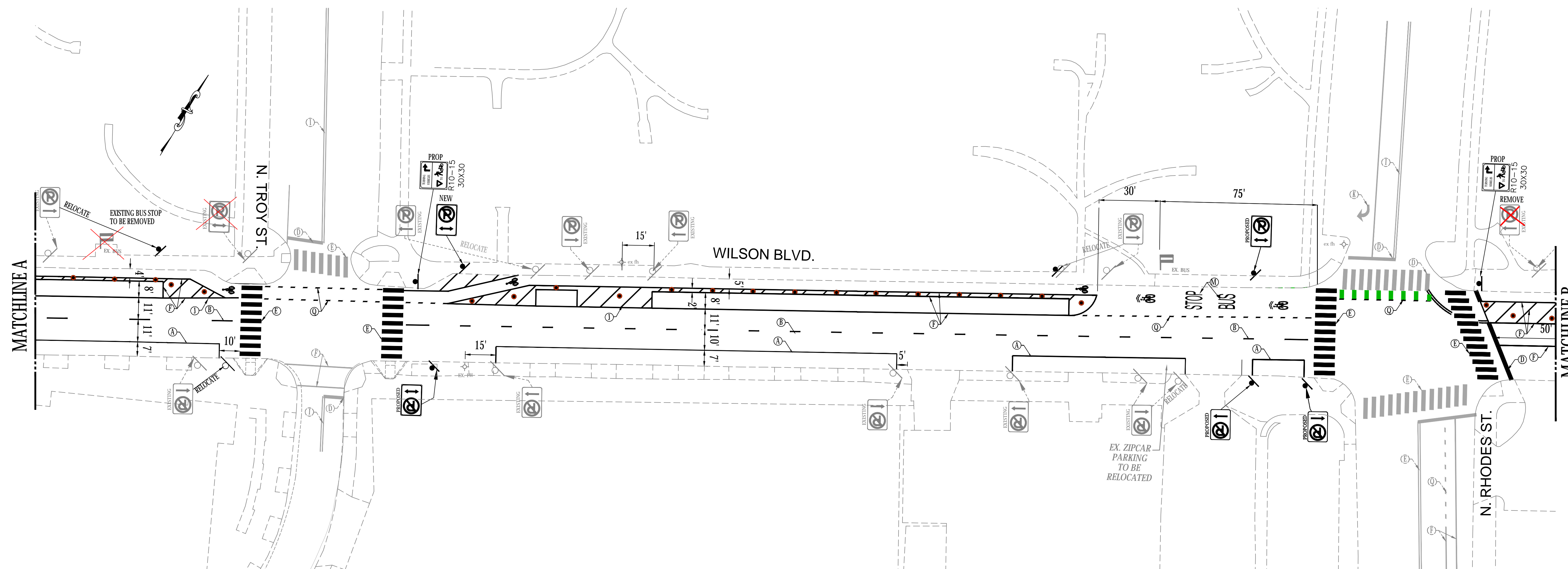

**STANDARD PAVEMENT MARKING LEGEND:**

Ⓐ TYPE B CLASS 1.....WHITE 4" WIDTH	PARKING LANES, EDGE LINES, LANE LINES
Ⓑ TYPE B CLASS 1.....WHITE 4" WIDTH, 10' LONG, 30' SPACING	DASHED LANE LINES
Ⓒ TYPE B CLASS 1.....WHITE 4" WIDTH, 2' LONG, 10' SPACING	LANE TRANSITIONS, TURN LANE SKIPS
Ⓓ TYPE B CLASS 1.....WHITE 18" WIDTH	STOP BARS
Ⓔ TYPE B CLASS 1.....WHITE 24" WIDTH	CONTINENTAL CROSS WALKS
Ⓕ TYPE B CLASS 1.....WHITE 6" WIDTH	TURN LANES, TRANSVERSE CROSSWALKS, BIKE LANES
Ⓖ TYPE B CLASS 1.....YELLOW 4" WIDTH, 10' LONG, 30' SPACING	DIVIDED TRAFFIC, TWO WAY TURN LANES
Ⓗ TYPE B CLASS 1.....YELLOW 4" WIDTH	EDGE LINES
Ⓙ TYPE B CLASS 1.....YELLOW 4" WIDTH, DOUBLE LINE, 4" SPACING	CENTERLINES
Ⓚ TYPE B CLASS 1.....WHITE 6" WIDTH, 10' SPACING @45 DEGREE	HATCH LINES, SAFETY ZONES
Ⓛ TYPE B CLASS 1.....WHITE SINGLE ARROW	TURN LANES
Ⓜ TYPE B CLASS 1.....WHITE COMBINATION ARROW	TURN LANES
Ⓝ TYPE B CLASS 1.....WHITE 8" LETTERS	PAVEMENT LETTERS (STOP, YIELD, BUS, ONLY etc.)
Ⓟ TYPE B CLASS 1.....WHITE 6" WIDTH, 2' LONG, 10' SPACING	LANE TRANSITIONS, TURN LANE SKIPS
Ⓠ TYPE B CLASS 1.....WHITE 12" WIDTH, 20' SPACING @45 DEGREE	CORE MARKINGS
Ⓡ TYPE B CLASS 1.....YELLOW 12" WIDTH, 20' SPACING @45 DEGREE	GORE MARKINGS
Ⓢ TYPE B CLASS 1.....WHITE 6" WIDTH, 2' LONG, 4" SPACING	LANE TRANSITIONS
Ⓣ TYPE B CLASS 1.....WHITE 4" WIDTH, DOUBLE LINE, 4" SPACING	CURB EXTENSIONS

- SIGN AND PAVEMENT MARKING NOTES:**
- STREET WIDTH MEASUREMENTS ARE FROM FACE OF CURB TO FACE OF CURB. LANES ARE MEASURED FROM CENTER OF MARKING TO CENTER OF MARKING.
  - CONTACT DENNIS HOWELL OR HIS DESIGNEE AT 703-228-6598 OR (571) 437-1077 TO APPROVE MARKING LAYOUT 48 HRS. PRIOR TO INSTALLATION OF MARKINGS.
  - PAVEMENT MARKINGS TO BE IN ACCORDANCE WITH THE FOLLOWING AND ANY REVISIONS HERE TO:
    - A) THE MANUAL ON UNIFORM TRAFFIC CONTROL DEVICES.
    - B) ARLINGTON COUNTY MARKING STANDARDS.
  - ALL MARKINGS SHALL BE THERMOPLASTIC PER ARLINGTON COUNTY MARKING STANDARDS.
  - STOP BARS SHALL BE A MINIMUM OF 4' IN ADVANCE OF A MARKED CROSSWALK. IF THERE IS NO MARKED CROSSWALK, STOP BAR SHALL BE NO MORE THAN 30' FROM THE NEAREST EDGE OF THE INTERSECTED TRAVELED WAY.
  - CROSSWALKS SHALL BE 10' WIDE UNLESS OTHERWISE NOTED.
  - LEFT TURN ARROWS SHALL BE LOCATED 25' BACK FROM STOP BAR. FOR ADDITIONAL ARROWS FOLLOW COUNTY MARKING STANDARDS.
  - ON STREET PARKING LANE IS 7' WIDE (UNLESS OTHERWISE NOTED) AND MARKED WITH 4" WIDE WHITE LINES. BEGINNING AND END OF PARKING SHALL BE MARKED WITH AN END LINE PERPENDICULAR TO CURB EXCEPT AT NUBS OR WHERE OTHERWISE INDICATED.
  - SHARED LANE MARKINGS SHALL BE PLACED IN CENTER OF LANE, 250' APART UNLESS OTHERWISE SPECIFIED.
  - BIKE LANE SYMBOLS TO BE PLACED 330' APART UNLESS OTHERWISE SPECIFIED.

**LEGEND**

EXISTING		PROPOSED
	BUS STOP	
	FIRE HYDRANT	
	PARKING METER	
	SIGN	
	STRIPING	

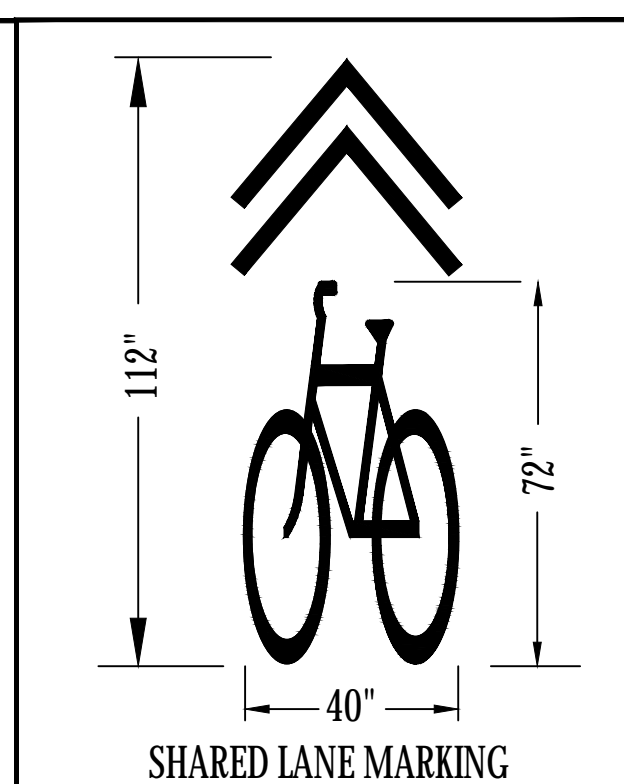
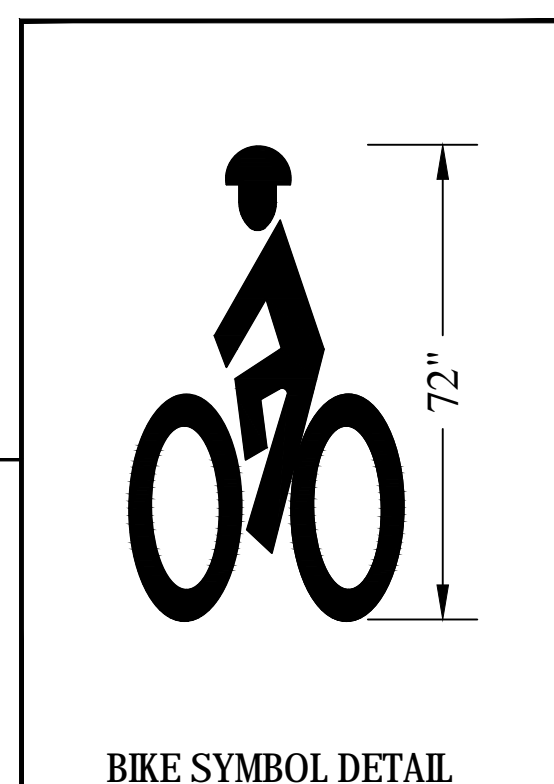
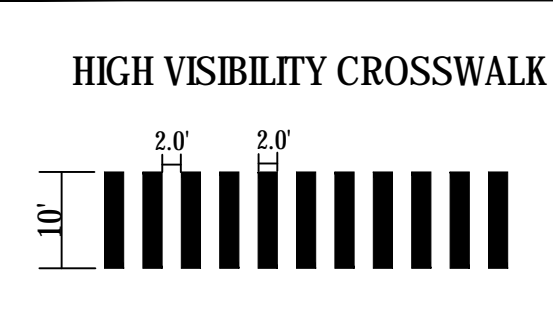

Project Name and Location

**Sign and Marking Plan**

Wilson Boulevard  
From: North Courthouse Road  
To: North Quinn Street

Designed: MF  
Drawn: MF  
Checked: DS/DN  
Miss Utility Transmittal #:  
Filename: MAR\_Wilson Blvd-N Courthouse Rd - N Quinn St-FINAL  
Path: Q:\Data\Traffic\Wilson Blvd-N Courthouse Rd\Drawings  
Plotted: Jul 20, 2018  
Plotted by: mfreeman

Scale: Hor: 1" = 25'



Seal

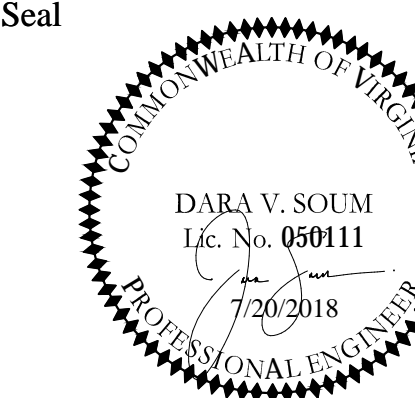

Approvals \_\_\_\_\_ Date \_\_\_\_\_

DESIGN TEAM SUPERVISOR \_\_\_\_\_

CHIEF T.E. & O. BUREAU \_\_\_\_\_

TRAFFIC SIGNAL ENGINEER \_\_\_\_\_

DEPARTMENT OF TRANSPORTATION \_\_\_\_\_

Revisions \_\_\_\_\_ Date \_\_\_\_\_

Project Name and Location

**Sign and Marking Plan**

Wilson Boulevard  
From: North Courthouse Road  
To: North Quinn Street

Designed: MF  
Drawn: MF  
Checked: DS/DN  
Miss Utility Transmittal #:  
Filename: MAR\_Wilson Blvd-N Courthouse Rd - N Quinn St-FINAL  
Path: Q:\Data\Traffic\Wilson Blvd-N Courthouse Rd\Drawings  
Plotted: Jul 20, 2018  
Plotted by: mfreeman  
Scale: Hor: 1" = 25'

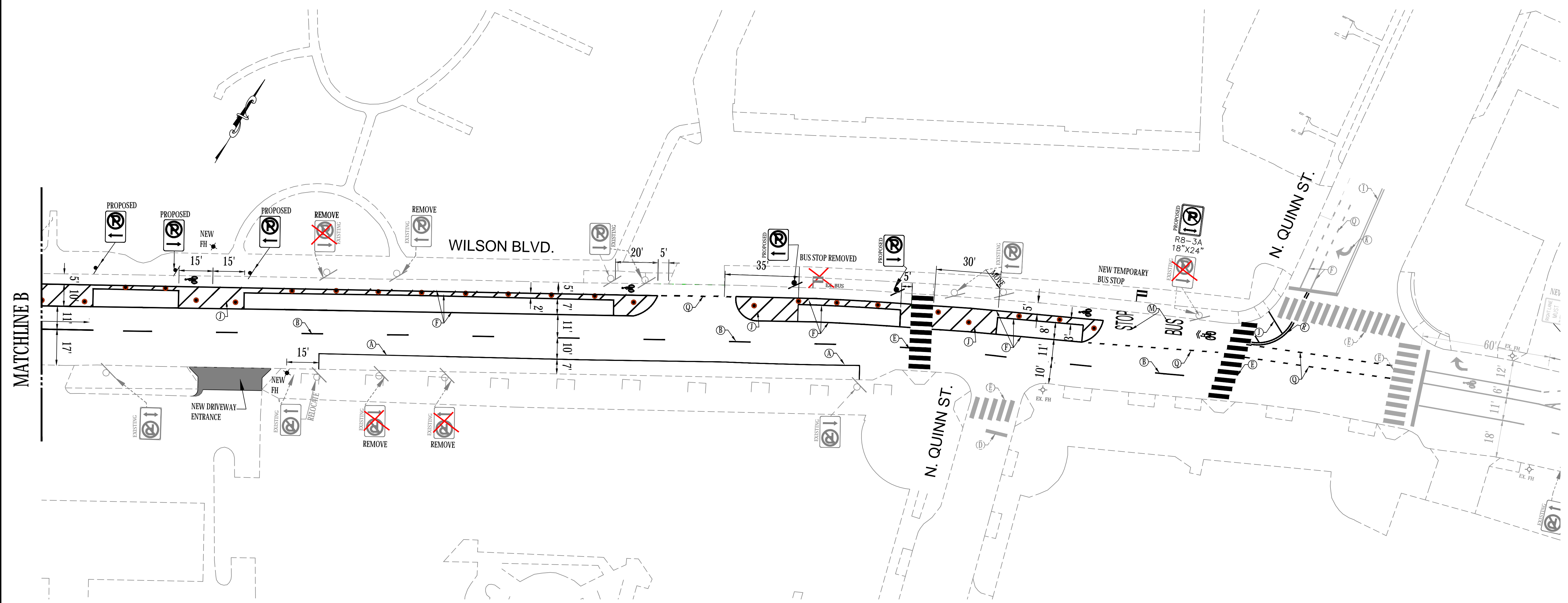

**STANDARD PAVEMENT MARKING LEGEND:**

Ⓐ TYPE B CLASS 1.....WHITE 4" WIDTH	PARKING LANES, EDGE LINES, LANE LINES
Ⓑ TYPE B CLASS 1.....WHITE 4" WIDTH, 10' LONG, 30' SPACING	DASHED LANE LINES
Ⓒ TYPE B CLASS 1.....WHITE 4" WIDTH, 2' LONG, 10' SPACING	LANE TRANSITIONS, TURN LANE SKIPS
Ⓓ TYPE B CLASS 1.....WHITE 18" WIDTH	STOP BARS
Ⓔ TYPE B CLASS 1.....WHITE 24" WIDTH	CONTINENTAL CROSS WALKS
Ⓕ TYPE B CLASS 1.....WHITE 6" WIDTH	TURN LANES, TRANSVERSE CROSSWALKS, BIKE LANES
Ⓖ TYPE B CLASS 1.....YELLOW 4" WIDTH, 10' LONG, 30' SPACING	DIVIDED TRAFFIC, TWO WAY TURN LANES
Ⓗ TYPE B CLASS 1.....YELLOW 4" WIDTH	EDGE LINES
Ⓙ TYPE B CLASS 1.....YELLOW 4" WIDTH, DOUBLE LINE, 4" SPACING	CENTERLINES
Ⓚ TYPE B CLASS 1.....WHITE 6" WIDTH, 10' SPACING @45 DEGREE	HATCH LINES, SAFETY ZONES
Ⓛ TYPE B CLASS 1.....WHITE SINGLE ARROW	TURN LANES
Ⓜ TYPE B CLASS 1.....WHITE COMBINATION ARROW	TURN LANES
Ⓝ TYPE B CLASS 1.....WHITE 8" LETTERS	PAVEMENT LETTERS (STOP, YIELD, BUS, ONLY etc.)
Ⓞ TYPE B CLASS 1.....WHITE 6" WIDTH, 2' LONG, 10' SPACING	LANE TRANSITIONS, TURN LANE SKIPS
Ⓟ TYPE B CLASS 1.....WHITE 12" WIDTH, 20' SPACING @45 DEGREE	CORE MARKINGS
Ⓠ TYPE B CLASS 1.....YELLOW 12" WIDTH, 20' SPACING @45 DEGREE	GORE MARKINGS
Ⓡ TYPE B CLASS 1.....WHITE 6" WIDTH, 2' LONG, 4" SPACING	LANE TRANSITIONS
Ⓢ TYPE B CLASS 1.....WHITE 4" WIDTH, DOUBLE LINE, 4" SPACING	CURB EXTENSIONS

- SIGN AND PAVEMENT MARKING NOTES:**
- STREET WIDTH MEASUREMENTS ARE FROM FACE OF CURB TO FACE OF CURB. LANES ARE MEASURED FROM CENTER OF MARKING TO CENTER OF MARKING.
  - CONTACT DENNIS HOWELL OR HIS DESIGNEE AT 703-228-6598 OR (571) 437-1077 TO APPROVE MARKING LAYOUT 48 HRS. PRIOR TO INSTALLATION OF MARKINGS.
  - PAVEMENT MARKINGS TO BE IN ACCORDANCE WITH THE FOLLOWING AND ANY REVISIONS HERE TO:  
A) THE MANUAL ON UNIFORM TRAFFIC CONTROL DEVICES.  
B) ARLINGTON COUNTY MARKING STANDARDS.
  - ALL MARKINGS SHALL BE THERMOPLASTIC PER ARLINGTON COUNTY MARKING STANDARDS.
  - STOP BARS SHALL BE A MINIMUM OF 4' IN ADVANCE OF A MARKED CROSSWALK. IF THERE IS NO MARKED CROSSWALK, STOP BAR SHALL BE NO MORE THAN 30' FROM THE NEAREST EDGE OF THE INTERSECTED TRAVELED WAY.
  - CROSSWALKS SHALL BE 10' WIDE UNLESS OTHERWISE NOTED.
  - LEFT TURN ARROWS SHALL BE LOCATED 25' BACK FROM STOP BAR. FOR ADDITIONAL ARROWS FOLLOW COUNTY MARKING STANDARDS.
  - ON STREET PARKING LANE IS 7' WIDE (UNLESS OTHERWISE NOTED) AND MARKED WITH 4" WIDE WHITE LINES. BEGINNING AND END OF PARKING SHALL BE MARKED WITH AN END LINE PERPENDICULAR TO CURB EXCEPT AT NUBS OR WHERE OTHERWISE INDICATED.
  - SHARED LANE MARKINGS SHALL BE PLACED IN CENTER OF LANE, 250' APART UNLESS OTHERWISE SPECIFIED.
  - BIKE LANE SYMBOLS TO BE PLACED 330' APART UNLESS OTHERWISE SPECIFIED.

**LEGEND**

EXISTING	PROPOSED

